

# TANAIR PNEUMATICS

## QUICK EXHAUST VALVE ( EAQ )

### • HOW TO ORDER

**EAQ 3 000 03**

1 Quick Exhaust

2 Body Size

2 - 1/4

3 - 3/8

4 - 1/2

3 Port Size

02 - Rc(PT)1/4 "

03 - Rc(PT)3/8 "

04 - Rc(PT)1/2 "

### SYMBOL

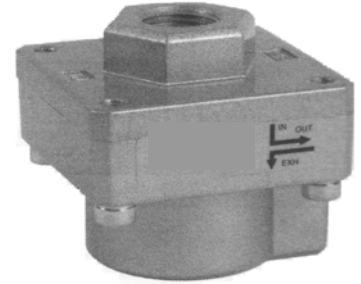
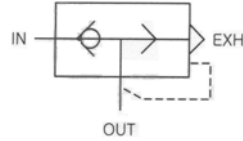

### SPECIFICATION

|                               |                                    |
|-------------------------------|------------------------------------|
| Fluid                         | Compressed Air                     |
| Max. supply pressure          | 1.5MPa [15.3 kgf/cm <sup>2</sup> ] |
| Max. operating pressure       | 0.97MPa [9.9 kgf/cm <sup>2</sup> ] |
| Ambient and media temperature | 5 ~ 60℃                            |
| Weight(g)                     | 235                                |

### STRUCTURE / PARTS

**EAQ 4000**

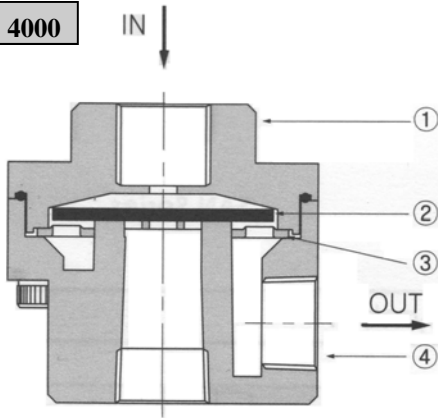

| No. | PARTS     | MATERIAL |
|-----|-----------|----------|
| 1   | Cover     | ALDC     |
| 2   | Diaphragm | NBR      |
| 3   | Plate     | STEEL    |
| 4   | Body      | ALDC     |

### DIMENSIONS ( mm )

