

# TAN AIR PNEUMATICS

## TPCM J.I.S TYPE CYLINDER

### BASIC TYPE

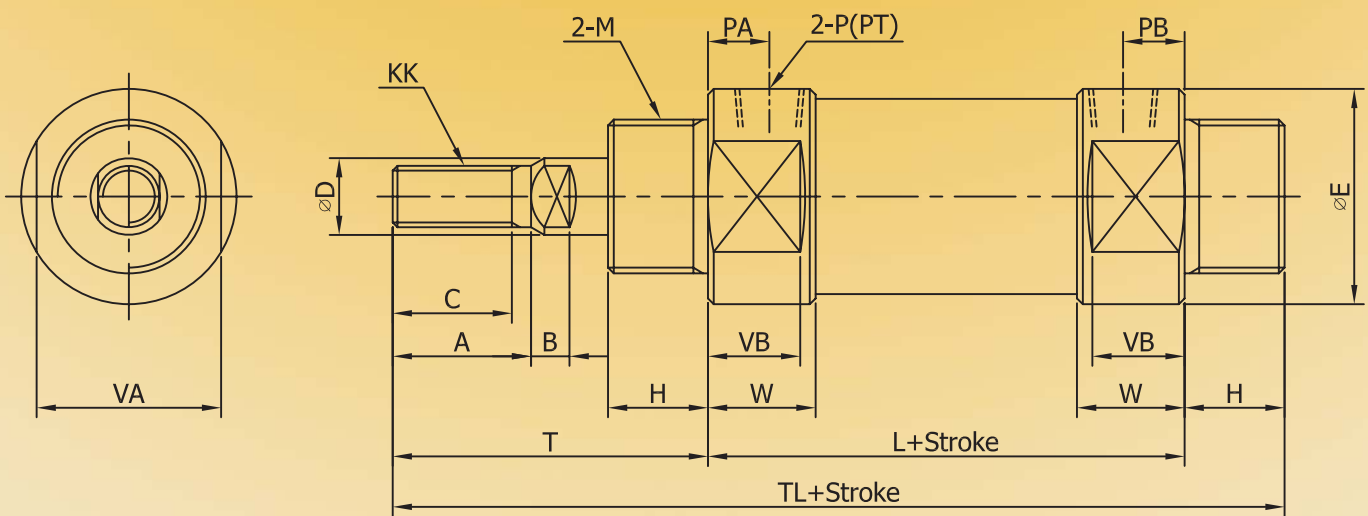

I-D(mm)	Stroke Range	C	A	D	H	PA	PB	E	B	KK
20	~300	15.5	18	10	13	8	8	28	5.0	M8*1.25
25	~300	19.5	22	12	13	8	8	34	5.5	M10*1.25
30	~300	19.5	22	12	13	8	8	38	5.5	M10*1.25
40	~300	21.0	24	16	16	11	11	50	7.5	M14*1.5

I-D(mm)	W	VA	VB	M	P(PT)	L	T	TL
20	14	24	12	M20*1.5	1/8	62	41	116
25	14	30	12	M26*1.5	1/8	62	45	120
30	15	32	12	M26*1.5	1/8	64	45	122
40	21	46	18	M32*2.0	1/4	68	50	154

# TAN AIR PNEUMATICS

## TPCM J.I.S TYPE CYLINDER

### L TYPE FOOT MOUNT

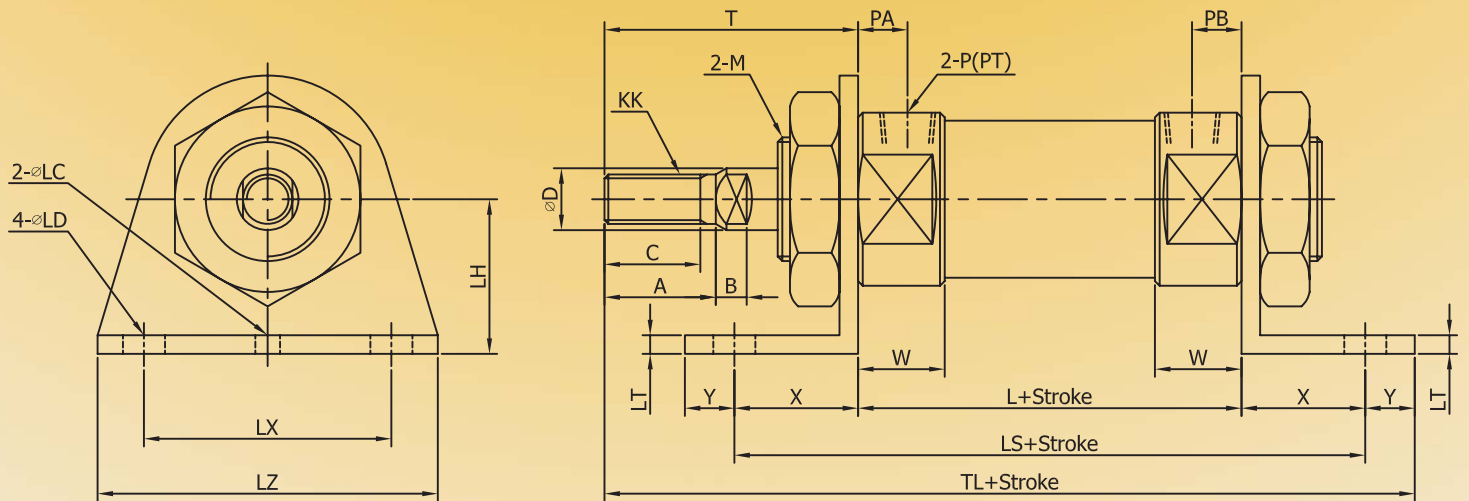

I-D(mm)	Stroke Range	C	A	D	H	PA	PB	LZ	B	KK
20	~300	15.5	18	10	13	8	8	55	5.0	M8*1.25
25	~300	19.5	22	12	13	8	8	55	5.5	M10*1.25
30	~300	19.5	22	12	13	8	8	55	5.5	M10*1.25
40	~300	21.0	24	16	16	11	11	75	7.5	M14*1.5

I-D(mm)	W	X	Y	M	P(PT)	L	T	TL	LC	LD	LH	LS
20	14	20	8	M20*1.5	1/8	62	41	131	4	6.8	25	102
25	14	20	8	M26*1.5	1/8	62	45	135	4	6.8	28	102
30	15	20	8	M26*1.5	1/8	64	45	137	4	6.8	28	104
40	21	23	12	M32*2.0	1/4	68	50	173	4	7.0	30	134

I-D(mm)	LT	LX
20	3	40
25	3	40
30	3	40
40	3	55

# TAN AIR PNEUMATICS

## TPCM J.I.S TYPE CYLINDER

### F TYPE FRONT FLANGE

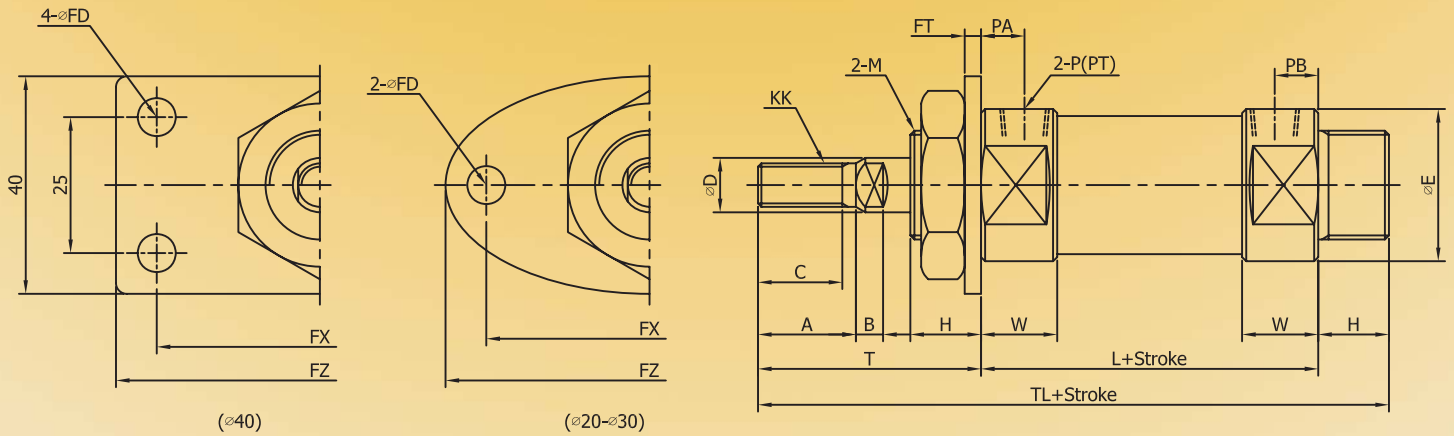

I-D(mm)	Stroke Range	C	A	D	H	PA	PB	E	B	KK
20	~300	15.5	18	10	13	8	8	28	5.0	M8*1.25
25	~300	19.5	22	12	13	8	8	34	5.5	M10*1.25
30	~300	19.5	22	12	13	8	8	38	5.5	M10*1.25
40	~300	21.0	24	16	16	11	11	50	7.5	M14*1.5

I-D(mm)	W	FD	FT	M	P(PT)	L	T	TL	FX	FY	FZ	Y
20	14	7	3	M20*1.5	1/8	62	41	116	116	-	75	40
25	14	7	4.5	M26*1.5	1/8	62	45	120	120	-	75	42
30	15	7	4.5	M26*1.5	1/8	64	45	122	122	-	75	42
40	21	7	4.5	M32*2.0	1/4	68	50	154	154	36	82	52

# TAN AIR PNEUMATICS

## TPCM J.I.S TYPE CYLINDER

### G TYPE REAR FLANGE

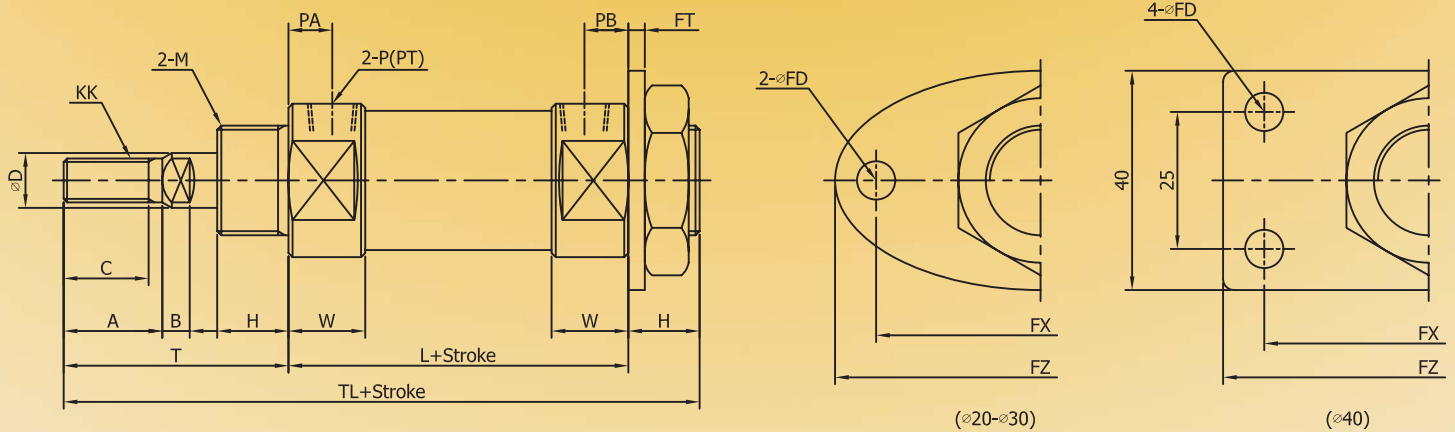

I-D(mm)	Stroke Range	C	A	D	H	PA	PB	Y	B	KK
20	~300	15.5	18	10	13	8	8	40	5.0	M8*1.25
25	~300	19.5	22	12	13	8	8	42	5.5	M10*1.25
30	~300	19.5	22	12	13	8	8	42	5.5	M10*1.25
40	~300	21.0	24	16	16	11	11	52	7.5	M14*1.5

I-D(mm)	W	FD	FT	M	P(PT)	L	T	TL	FX	FY	FZ
20	14	7	3	M20*1.5	1/8	62	41	116	116	-	75
25	14	7	4.5	M26*1.5	1/8	62	45	120	120	-	75
30	15	7	4.5	M26*1.5	1/8	64	45	122	122	-	75
40	21	7	4.5	M32*2.0	1/4	68	50	154	154	36	82

# TAN AIR PNEUMATICS

## TPCM J.I.S TYPE CYLINDER

### C TYPE SINGLE REAR CLEVIS

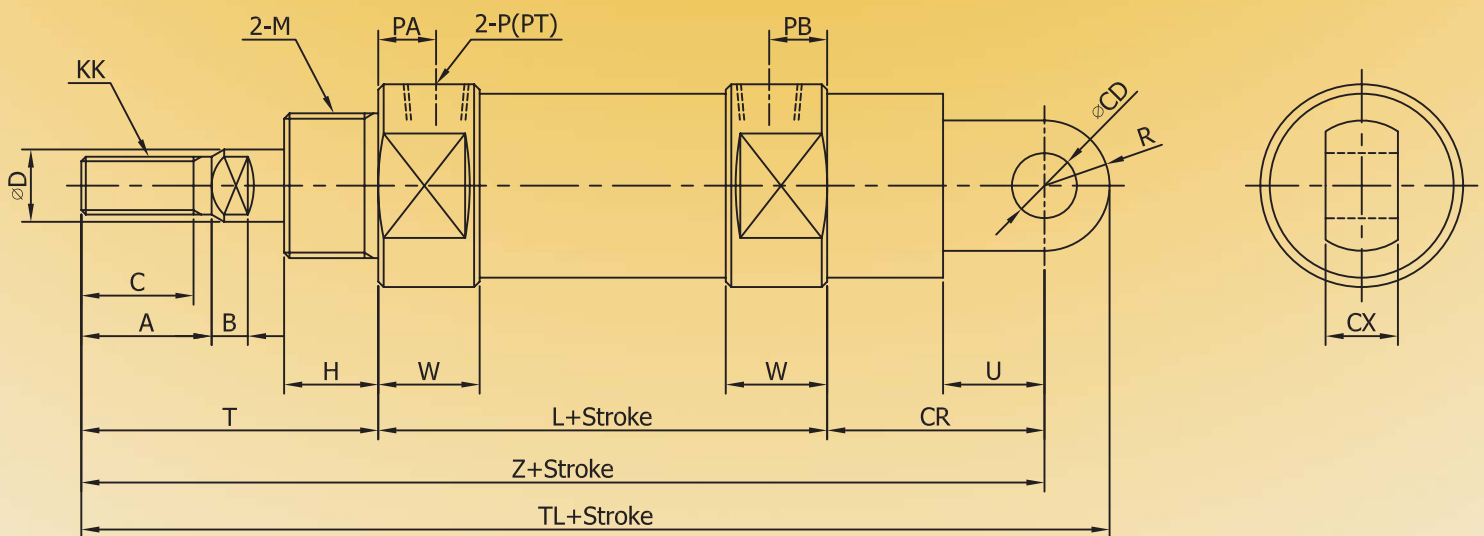

I-D(mm)	Stroke Range	C	A	D	H	PA	PB	T	B	KK
20	~300	15.5	18	10	13	8	8	41	5.0	M8*1.25
25	~300	19.5	22	12	13	8	8	45	5.5	M10*1.25
30	~300	19.5	22	12	13	8	8	45	5.5	M10*1.25
40	~300	21.0	24	16	16	11	11	50	7.5	M14*1.5

I-D(mm)	W	Z	TL	M	P(PT)	L	CR	U	CD	CX	R
20	14	133	142	M20*1.5	1/8	62	30	14	9	10	9
25	14	137	146	M26*1.5	1/8	62	30	14	9	10	9
30	15	139	148	M26*1.5	1/8	64	30	14	9	10	9
40	21	177	188	M32*2.0	1/4	68	39	18	10	15	10

# TAN AIR PNEUMATICS

## TPCM J.I.S TYPE CYLINDER

### D TYPE DOUBLE REAR CLEVIS

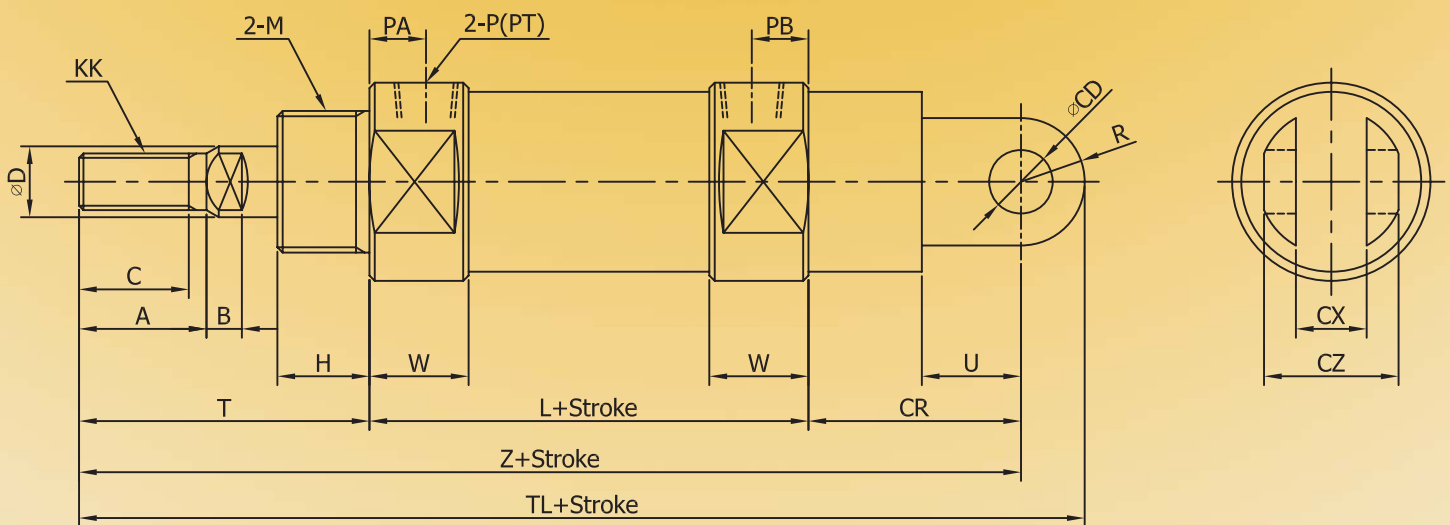

I-D(mm)	Stroke Range	C	A	D	H	PA	PB	T	B	KK
20	~300	15.5	18	10	13	8	8	41	5.0	M8*1.25
25	~300	19.5	22	12	13	8	8	45	5.5	M10*1.25
30	~300	19.5	22	12	13	8	8	45	5.5	M10*1.25
40	~300	21.0	24	16	16	11	11	50	7.5	M14*1.5

I-D(mm)	W	Z	TL	M	P(PT)	L	CR	U	CD	CX	CZ	R
20	14	133	142	M20*1.5	1/8	62	30	14	9	10	19	9
25	14	137	146	M26*1.5	1/8	62	30	14	9	10	19	9
30	15	139	148	M26*1.5	1/8	64	30	14	9	10	19	9
40	21	177	188	M32*2.0	1/4	68	39	18	10	15	30	10

# TAN AIR PNEUMATICS

## TPCM J.I.S TYPE CYLINDER

### T TYPE FRONT TRUNION

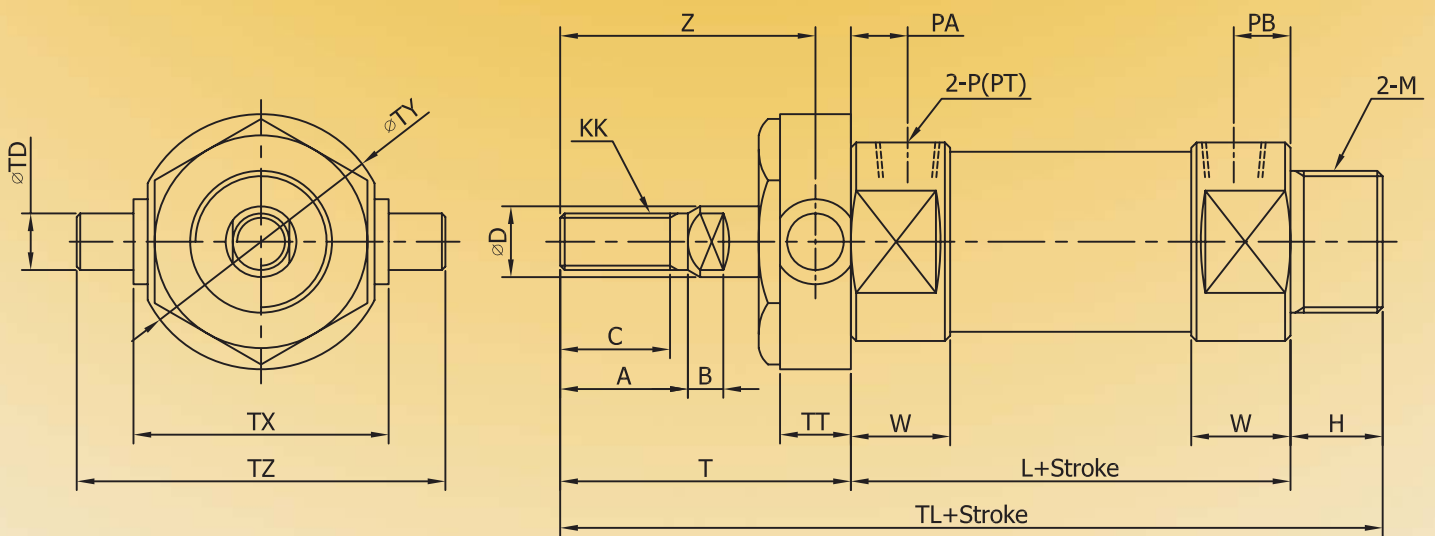

I-D(mm)	Stroke Range	C	A	D	H	PA	PB	T	B	KK
20	~300	15.5	18	10	13	8	8	41	5.0	M8*1.25
25	~300	19.5	22	12	13	8	8	45	5.5	M10*1.25
30	~300	19.5	22	12	13	8	8	45	5.5	M10*1.25
40	~300	21.0	24	16	16	11	11	50	7.5	M14*1.5

I-D(mm)	W	Z	TL	M	P(PT)	L	TD	TT	TX	TY	TZ
20	14	36	116	M20*1.5	1/8	62	8	10	32	32	52
25	14	40	120	M26*1.5	1/8	62	9	10	40	40	60
30	15	40	122	M26*1.5	1/8	64	9	10	40	40	60
40	21	44.5	154	M32*2.0	1/4	68	10	11	53	53	77

# TAN AIR PNEUMATICS

## TPCM J.I.S TYPE CYLINDER

### T TYPE REAR TRUNION

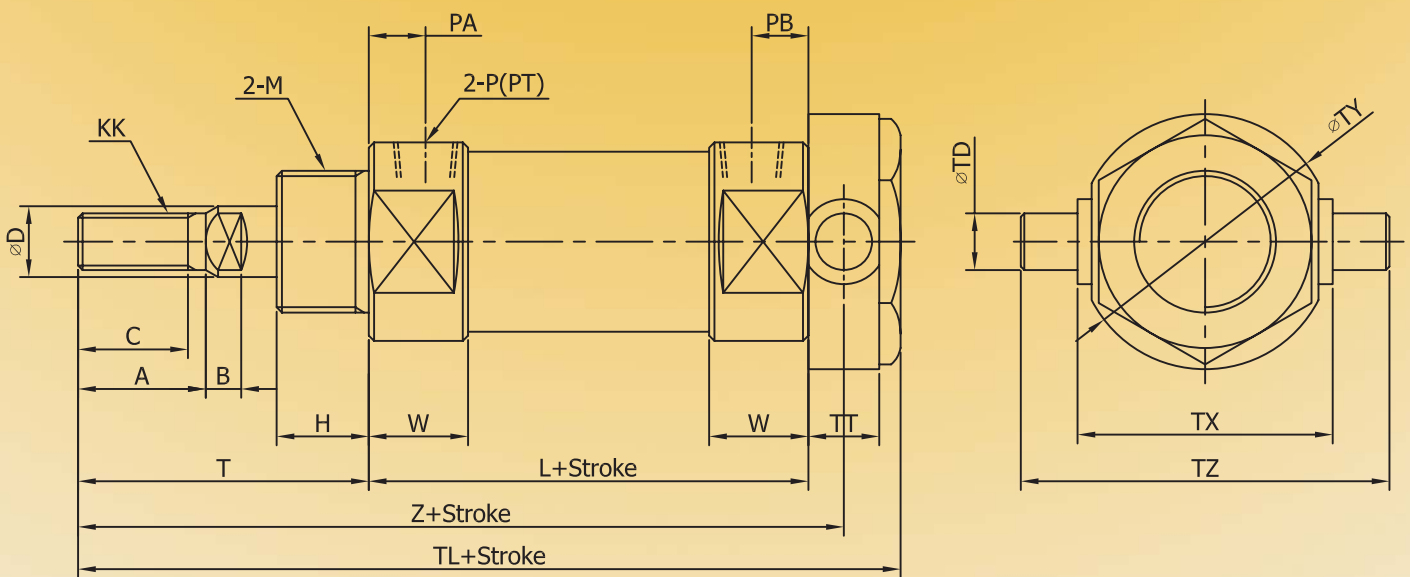

I-D(mm)	Stroke Range	C	A	D	H	PA	PB	T	B	KK
20	~300	15.5	18	10	13	8	8	41	5.0	M8*1.25
25	~300	19.5	22	12	13	8	8	45	5.5	M10*1.25
30	~300	19.5	22	12	13	8	8	45	5.5	M10*1.25
40	~300	21.0	24	16	16	11	11	50	7.5	M14*1.5

I-D(mm)	W	Z	TL	M	P(PT)	L	TD	TT	TX	TY	TZ
20	14	108	118	M20*1.5	1/8	62	8	10	32	32	52
25	14	112	122	M26*1.5	1/8	62	9	10	40	40	60
30	15	114	124	M26*1.5	1/8	64	9	10	40	40	60
40	21	143.5	154	M32*2.0	1/4	68	10	11	53	53	77

# TAN AIR PNEUMATICS

## TPCM J.I.S TYPE CYLINDER

I TYPE SINGLE KNUCKLE JOINT

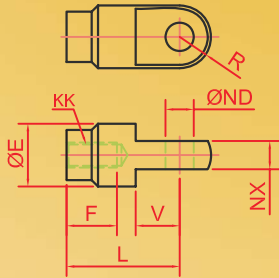

I-D	F	E	L	KK	R	V	ND	NX
20	16	20	36	M8*1.25	10	14	9	9
25,30	18	20	38	M10*1.25	10	14	9	9
40	22	24	55	M14*1.5	15.5	20	12	16

KNUCKLE JOINT PIN

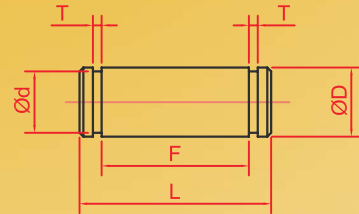

I-D	D	d	L	F	T
20	9	8	25	19.2	1.15
25	9	8	25	19.2	1.15
30	10	9	36.5	30.2	1.3
40	12	11	44.5	38.2	1.3

Y TYPE DOUBLE KNUCKLE JOINT

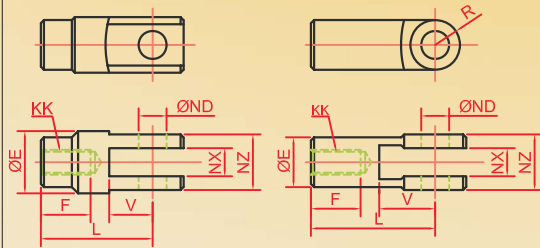

I-D	F	E	L	KK	R	V	ND	NX	NZ
20	16	20	36	M8*1.25	12	14	9	9	18
25,30	18	20	38	M10*1.25	12	14	9	9	18
40	22	24	55	M14*1.5	13	25	12	16	38

NOSE MOUNTING NUT

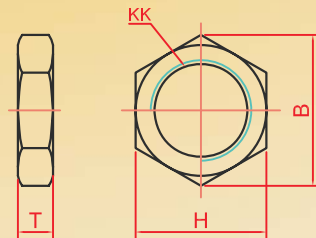

I-D	KK	T	H	B
20	M20*1.5	7	26	30
25	M26*1.5	8	32	37
30	M32*2.0	8	41	47.3

NOSE MOUNTING NUT

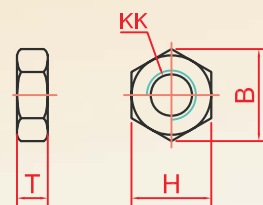

I-D	KK	T	H	B
20	M8*1.25	5	13	15.0
25	M10*1.25	8	17	19.6
30	M14*1.5	8	22	25.4